

Working principle

PTF520 Pitot tube flow meter is COMATE's latest technology base on different pressure technology specially designed for compressed air applications. As it has 1/2" insertion connection probe and compact designed sensor, it can be used on pipes from DN25~DN300. In some higher pressure applications, it can be installed / removed without stopping the fluid, as the pipe is thinner, field engineers will be able to insert the meter to pipe very easily. Also, due to its working principle, it is less effected by the water contents in the compressed air.

PTF520 Pitot tube flow meter also has integral temperature and pressure compensation, so it can measure standard flow, temperature and pressure also.

Special features

- Cellphone APP for reading and setting
- Self-diagnose and remote diagnose function to provide with best support
- Bid-directional flow measurement
- No need to set 0 point
- Measures flow rate, temperature, pressure, FAD measurement available
- Wide measurement range
- Fast response time
- No mechanical wear part
- Insertion mounting, available for hot tapping.
- For both dry and wet air measurement, possible for measuring compressed air at output of compressor



Socket tube (Material according to pipeline)

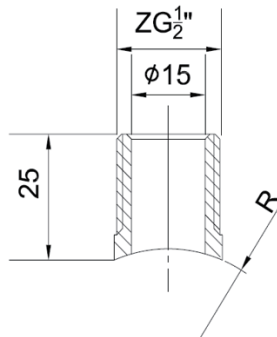

Read & Set on Screen

PTF520 has integral TFT 2" High Resolution display with two capacitive key for setting

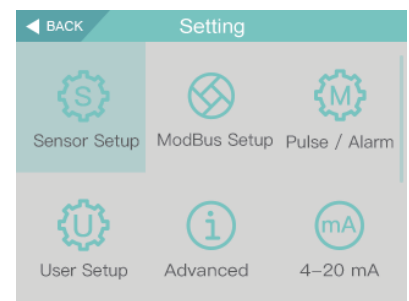
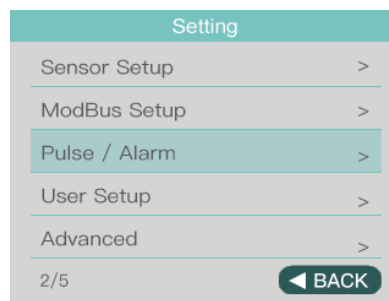
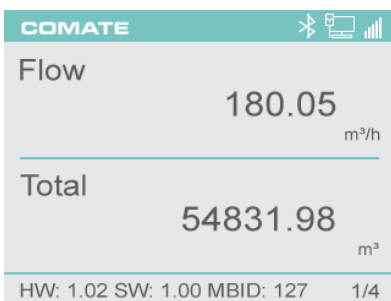

Read & Set on in COMATE APP

Instead of traditional keyboard, COMATE PTF500 implement a cellphone setting system. All PTF500 have Bluetooth communication. Users can install COMATE APP on their cellphone or tablet and use the APP to connect with a PTF520 flow meter to read or set the flow meter.

This APP also support a remote diagnose function. Whenever there is anything wrong with the flow meter, customer can ask for a remote diagnose support. When this function is working, COMATE engineer back in office can remotely check the setting of the meter, and the signal of sensor, to provide users with most accurate trouble shooting advise.

COMATE APP has made the using of the product simple and efficient .

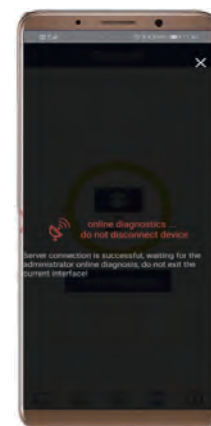
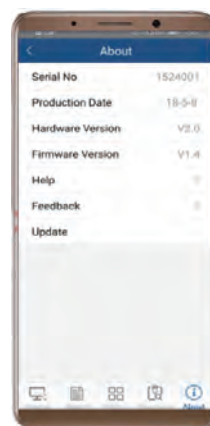
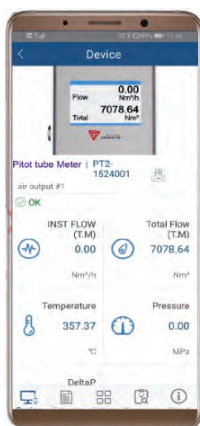

Device list

Setting interface

Remote diagnose interface

Mode number

The standard model number is usually PTF600-I1-T-1-1-XXXX,
Please reference to the table below for what the model codes stand for.

Mode codes

1	General model	D	Insertion (G 1/2) ,anti-ejection design with ball valve	Standard
		1	255mm, 11mm dia (1"~4" or DN25~DN100)	Option
2	Probe Length	2	320mm, 11mm dia (1"~8" or DN25~DN200)	Option
		3	395mm, 11mm dia (1"~12" or DN25~DN300)	Standard
3	Probe Material	1	304 SS	Standard
		1	Carbon steel	Standard
4	Socket material	2	304 SS	Option
		3	316 SS	Option
5	Transmitter	T	Integral	Standard
6	Pressure Rating	1	10 Bar G	Standard
		2	150 KpaA	Option
7	Display and output	1	Local display, RS485, Bluetooth	Standard
		2	Local display, 4wire 4~20mA, RS485, Bluetooth	Option
8	Power supply	1	13.5~42VDC	Standard
		N	13.5~42VDC with 24VDC to AC power converter	N
9	Pipe size	XXX	please use 3 digit pipe size, such as DN50=050, DN200=200	XXX

Remark:

1. Hot-tap hole opener are as accessories, please remark if you need any of them
2. Please indicate flow rate along with the model number selected
3. If anything beyond this chart, please check with us to see the availability
4. The model selected in 1st line is the standard configuration with no accessories